

APPLICATION

Small aperture medium distribution downlight is suitable for commercial, retail and institutional applications that require a flush mount micro-flange trim.

PRODUCT DATA

REFLECTOR: The parabolic reflector redirects spill light from the lamp, and eliminates high angle glare. Narrow (3/16") trim flange is flush with ceiling line for a clean appearance and smooth transition between the ceiling and fixture aperture. Supplied standard with Specular Clear Alzak, other reflector finishes are available in order to provide maximum flexibility to the designer.

HOUSING: Heavy gauge galvanized steel housing provides a secure mounting platform for the electrical components and protects the optical assembly. Integral plaster ring allows drywall compound to be applied up to edge of aperture. Trim flange rests in a flush mount position with drywall compound. Housing can be mechanically fastened to drywall to prevent movement and eliminate cracking or chipping.

MOUNTING: Universal mounting brackets adjust vertically 2.5" and accept a variety of hanger bars, C-Channel, EMT or rigid bars (see optional accessories). For slope ceiling consult special section of catalog.

ELECTRICAL: 120 to 277 volt input 50 to 60 Hz high power factor electronic ballasts are programmed start, under 10% THD. Consult Technical Section for additional ballast operating data. Optional emergency ballast (-EM) operates one lamp for 90 minutes, faceplate with test switch and charger light. Integral push to test switch available. Contact factory for more information.

JUNCTION BOX: Heavy gauge galvanized junction box pre-wired with grounding pigtail. Easy access covers. Multiple conduit knockouts listed for through branch circuit wiring.

SOCKET: Positive latch four pin thermoplastic. 26, 32 and 42 watt models feature a twist lock socket. 13 and 18 watt models feature a push in socket. Triple tube models have field adjustable socket position to allow conversion to alternate wattage.

LAMP DATA:

LAMP	WATTS	BASE	BALLAST	LUMENS
Triple Tube 4-Pin	26	GX24q-3	Elec.	1800
	32	GX24q-3	Elec.	2400
	42	GX24q-4	Elec.	3200
Quad Tube 4-Pin	13	G24q-1	Elec.	900
	18	G24q-2	Elec.	1250
	26	G24q-3	Elec.	1800

Standard lamping, initial lumens.

Manufactured and tested to UL#1598 and CSA standards. Note: Suitable for damp location and wet location under covered ceiling.

Catalog #:

6HF

Example: 6HF126TE4

Fixture Series	Lamp/Wattage	Ballast/Voltage*	Options
6HF	QTY	E4 / Electronic 120/277 D1 / 120V Lutron Dimming D2 / 277V Lutron Dimming *Refer to separate page for dimming ballast specifications and availability of other styles.	NF – Flush Mount Housing See Below for Additional Options
	TYPE		
	(Triple Tube)		
	1 26T		
	1 32T		
(Quad Tube)			
1 or 2 13Q			
1 or 2 18Q			
1 or 2 26Q			

Optional Accessories

Hanger Bars (set of 2)

- 101782 = #520 Caddy Bars
- 9152 = 52" C-Channel
- 9127 = 27" C-Channel
- 27BH = 27" Solid Bar
- 24CBH = 24" one-piece B-Line C-Channel hanger bar
- 26UBH = interlocking hanger bars expand to 26"

Fixture:	Type:
Project:	

Coventry

Architectural Series

SERIES 6HF-NF Flush Mount Horizontal Fluorescent Downlight

- Open reflectors are not suitable for air handling plenums

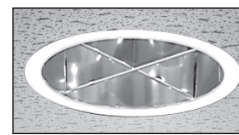
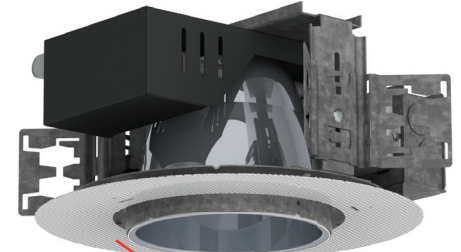

XB – Cross Blade Louver

Anchor ring allows drywall to be secured to product minimizing movement, reducing cracks. Anchor ring adjusts for ceiling thickness of 1/2", 5/8", 3/4", 1"

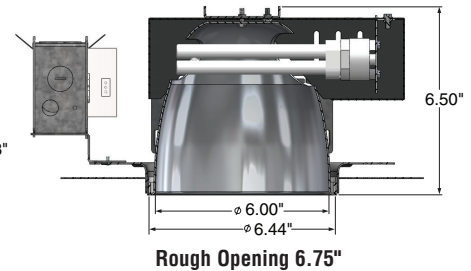
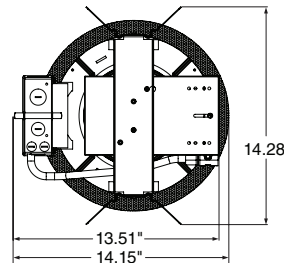

Intertek
Listed For Wet Location
Under Covered Ceiling

6HF1

Example: 6HF1SCLPF

Trim	Trim Finish w/polished flange
6HF1	– One Lamp Reflector
6HF2	– Two Lamp Reflector
XB	– Optional Cross Blade Parabolic Louver
SCLPF	– Soft Specular Clear Alzak
NF	– Flush Mount Trim

Options

- EM = Emergency Battery Pack w/remotely located Test Switch
- EMITS = Emergency Battery Pack with Integral Test Switch installed in reflector
- F = Fused

A wide variety of Decorative Element styles can be found in separate brochure.

All Pathway® products meet or exceed requirements as established by the National Electrical Code. Specifications subject to change without notice. Alzak® is a registered trademark of Alcoa.

PHOTOMETRIC DOWNLIGHT DISTRIBUTION

Catalog No. – 6HF132TE4NF / 6HF1SCLPFNF
Lamp(s) – (1) 32W PLT
Lumens – 2400
Spacing Criteria – 1.43
Efficiency – 56.3%

CANDELA DISTRIBUTION

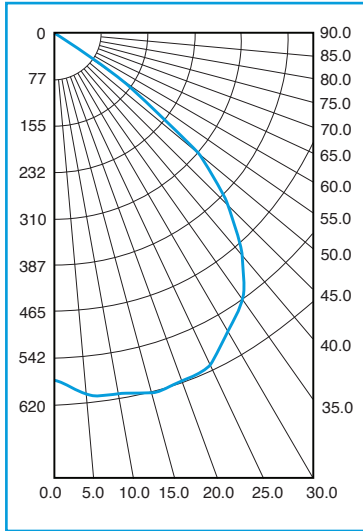

CANDELA

VERTICAL ANGLE	0
0.00	578
5.00	605
10.00	609
15.00	621
20.00	617
25.00	610
30.00	573
35.00	542
40.00	479
45.00	381
50.00	279
55.00	109
60.00	23.6
65.00	4.03
70.00	1.82
75.00	1.54
80.00	0.480
85.00	0.390
90.00	0.000

CONE OF LIGHT

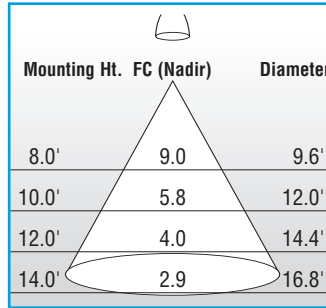

Initial Footcandles at a 30° Work Plane
 Beam diameter calculated at 50% of maximum fc at nadir.

ZONAL LUMENS SUMMARY

ZONE	LUMENS	% LAMP	% LUMINAIRE
0- 30	539	22.4	39.9
0- 40	897	37.4	66.4
0- 60	1341	55.9	99.3
0- 90	1351	56.3	100.0
90-120	0	0.0	0.0
90-130	0	0.0	0.0
90-150	0	0.0	0.0
90-180	0	0.0	0.0
0-180	1351	56.3	100.0

COEFFICIENTS OF UTILIZATION

PCC PW	.8				.7				.5			.3			.1			0		
	.7	.5	.3	.1	.7	.5	.3	.1	.5	.3	.1	.5	.3	.1	.5	.3	.1	.5	.3	.1
RCR																				
0	66	66	66	66	65	65	65	65	62	62	62	59	59	59	57	57	57	56		
1	62	61	59	57	61	59	58	56	57	56	55	55	54	53	53	52	52	50		
2	58	55	52	50	57	54	51	49	52	50	48	50	49	47	49	47	46	45		
3	54	50	46	44	53	49	46	43	47	45	42	46	44	42	45	43	41	40		
4	51	45	41	38	49	45	41	38	43	40	38	42	39	37	41	39	37	36		
5	47	41	37	34	46	41	37	34	39	36	33	38	35	33	37	35	33	32		
6	44	37	33	30	43	37	33	30	36	32	30	35	32	30	34	32	29	28		
7	41	34	30	27	40	34	30	27	33	29	27	32	29	27	32	29	26	25		
8	38	31	27	24	37	31	27	24	30	27	24	30	26	24	29	26	24	23		
9	36	29	25	22	35	29	25	22	28	24	22	27	24	22	27	24	22	21		
10	33	27	23	20	33	26	23	20	26	22	20	25	22	20	25	22	20	19		

PFC = 0.20

AVERAGE LUMINANCE

Angle	CD/M ²
45°	29560
55°	10420
65°	522
75°	326
85°	245