

SERIES TB6

Decorative LED Cylinders
1064-6463 Lumens

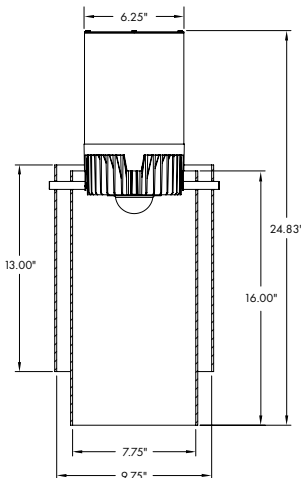

weight: 10.75 lbs

APPLICATION

A decorative cylinder lighting fixture is ideal for application that require long lamp life and energy saving benefits of LED technology.

FEATURES AND BENEFITS

- Architectural aluminum cylinder housing with powder coat finish.
- Mounting options include: Pendant Stem, Wall, Surface, and Cord.
- Emergency option (IEM) available using special ceiling canopy.
- Custom colors available.
- Separate models available for our remote driver platforms of IRD and CentralDrive™ (see below).

TECHNICAL DATA

- Input: 120 to 277 VAC, 50-60Hz
- 0-10V 1% (linear) and forward/reverse phase (120V) dimming. Other options listed on page 3.
- CRI = 80. Available in 90 CRI.
- Available with Bridgelux Thrive™ high-fidelity human-centric lighting technology.
- Expected lamp life to be 50,000 hours with 70% lumen maintenance when ambient temperatures do not exceed 35°C. Lower ambient temperatures yield longer lamp life.

REMOTE DRIVER OPTIONS (PUBLISHED SEPARATELY)

IRD (In-ceiling Remote Driver) features a housing with driver that is recessed in the ceiling and operates a single lighting fixture. Benefits include small 0.25" thick ceiling canopies, emergency (EM) options, and longer driver life due to reduced exposure to the heat of the LED engine. Both new construction and remodel style housings are available.

CentralDrive™ system features a remote panel that operates multiple lighting fixtures. This remote panel can be installed in an easy-to-access area such as a utility closet. Benefits are the same as our IRD system as well as easy driver replacement.

Lighting fixtures for these remote driver systems are published separately and can be found on our website. Please contact our sales team for more information on these options.



HOW TO ORDER

Catalog #:
Example: TB6A1V1035DASA

Fixture Series	Mounting	Driver	Delivered Lumens	Thrive™	Color Temp.
TB6	A ¹ = Aviation Cable W = Wall Mount P = Pendant Mount S = Surface Mount	V = On Board Driver	10 = 1064L, 9.9W 20 = 2294L, 20.1W 30 = 3175L, 28.4W 40 = 4057L, 36.6W 50 = 5242L, 49.7W 60 = 6075L, 59.0W 65 = 6463L, 63.2W 9 = 90 CRI	T = Thrive High Fidelity Human Centric Technology 95 CRI. Use scaling factor of 0.54 to determine delivered lumens.	5 (5000K) 4 (4000K) 35 (3500K) 3 (3000K) 27 (2700K)
	Conduit Canopies CA ¹ = Aviation Cable CP ² = Pendant Stem CS = Surface				

Dimming	Finish	Heat Sink Finish	Options
DA = Titanium 1% 0-10V(linear) is standard. More options on next page.	MW = Matte White SA = Satin Aluminum MB = Matte Black BZ = Bronze COLORS (See Last Page)	Blank = Matte Black 1 = Matte White 2 = Satin Aluminum 3 = Bronze 5 = Gloss White 6 = Gloss Black M = Match Cylinder Housing	F = Fuse and Fuse Holder IEM = EM Battery Pack w/ Integral Test Switch. Special Ceiling Canopy Required. Not available in wall mount.

¹ Specify canopy and cord color using "A" followed by number, e.g. "A2"
 1 = White canopy/ White cord 5 = Bronze canopy/ White cord 9 = White canopy/ Clear cord
 2 = White canopy/ Black cord 6 = Bronze canopy/ Black cord 10 = Black canopy/ Clear cord
 3 = Black canopy/ White cord 7 = Silver canopy/ White cord 11 = Silver canopy/ Clear cord
 4 = Black canopy/ Black cord 8 = Silver canopy/ Black cord 12 = Bronze canopy/ Clear cord

² Specify canopy finish using "CP" followed by letter, e.g. "CPW": W = Matte White, B = Matte Black, A = Satin Aluminum, Z = Bronze. Stem length specified separately, see below "PKU".

Stem Kit Specification:
Example: PRDR24SA

Pendant Stem	Stem Length	Finish
PRDR = Swivel Pendant Kit For "P" Mounting Style. Add .25" for canopy. PKU = Swivel Pendants Kit for Conduit Canopy, "CP" mounting style. Add 4" for canopy.	Stem Length in increments of 12 inches. Can be cut to length in field	SA = Satin Aluminum W = White B = Black Z = Bronze

Fixture:	Type:
Project:	

Manufactured and tested to UL#1598/8750 and CSA standards.
All Pathway® products meet or exceed requirements as established by the National Electrical Code. Specifications subject to change without notice.

DIMMING OPTIONS

Specify option by suffix (shown in bold-face type)

Our White Paper regarding Linear vs. Logarithmic Operating Characteristics is available in our 'Downloads' section of our website, or you may request one by emailing Sales@PathwayLighting.com

0-10V Dimming Options	Lutron Dimming Options	DALI Dimming Options	Tri-mode Dimming Options
DA = Xitanium 1% 0-10V (linear) DB = Xitanium 1% 0-10V (logarithmic) DC = EldoLED 0-10V 0% (logarithmic) DD = EldoLED 0-10V 1% (logarithmic) DE = EldoLED 0-10V 0% (linear) DF = EldoLED 0-10V 1% (linear)	Maximum Lumen Designation of 50 DG = Lutron Eco 1% (linear) DJ = Lutron 2 wire 1% (linear)	DK = EldoLED DALI 0% (logarithmic) DL = EldoLED DALI 1% (logarithmic)	Maximum Lumen Designation of 60 DQ = 2-wire forward/reverse phase (120V) and 0-10V (1% linear)

DMX [^] Dimming Options (interfaced through 0-10V driver)	DMX Dimming Options RDM Compliant
XA = DMX Xitanium 1% (linear) [^] XB = DMX Xitanium 1% (logarithmic) [^] XC = DMX EldoLED 0% (logarithmic) [^] XD = DMX EldoLED 1% (logarithmic) [^] XE = DMX EldoLED 0% (linear) [^] XF = DMX EldoLED 1% (linear) [^]	Maximum Lumen Designation of 40 XG = EldoLED 0% (logarithmic) XH = EldoLED 0% (linear)

[^] These options are not compatible with emergency battery options. Not compatible with surface conduit canopies.

DELIVERED LUMENS DATA

Data based on fixture with 3500K Color Temperature

FIXTURE	WATTAGE	RATED LUMENS	DELIVERED LUMENS	BEAM DISTRIBUTION	LPW
TB6V1035	9.9	1000	1064	30°	107
TB6V2035	20.1	2000	2294	30°	114
TB6V3035	28.4	3000	3175	30°	112
TB6V4035	36.6	4000	4057	30°	111
TB6V5035	49.7	5000	5242	30°	105
TB6V6035	59.0	6000	6075	30°	103
TB6V6535	63.2	6500	6463	30°	102



Above values reflect 3500K color temperatures



Scaling factors for other color temperatures: 2700K=0.92; 3000K=0.97; 4000K=1.01; 5000K=1.04

Scaling Factor for 90 CRI=0.83

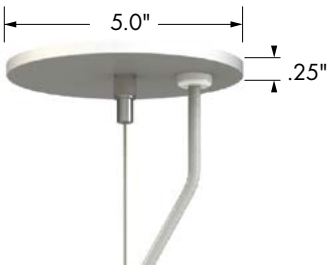
Scaling Factor for Thrive = 0.54

MOUNTING CONFIGURATIONS

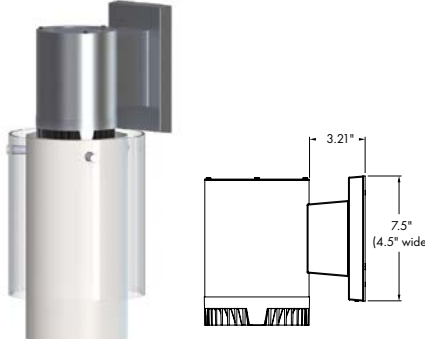
Aviation Cable (A)	Pendant Mount (P)	Surface (S)
 <p>Supplied with 10' field adjustable aviation cable and straight cord. Contact Sales Department for custom lengths.</p>	 <p>Swivel mount pendant stem product allows cylinder to hang plumb up to 45° sloped ceiling. All stems are 3/8" IPS and specified in increments of 12 inches. They can be easily cut to specific length in field. Standard finish white powder coat.</p>	 <p>Provided with mounting holes for securement to 4" octagon junction box. Canopy adds .25" to overall height</p>

Wall Mount (W)	Universal Ceiling Canopy	Emergency Ceiling Canopy
 <p>Standard bracket protrudes 3.21" from wall and measures 7.5" tall by 4.5" wide. Mounts to 4" octagon junction box.</p>	 <p>For DMX option. Available for surface, pendant stem and straight cord mounting styles.</p>	 <p>Available for surface, pendant stem and straight cord mounting styles and emergency options (IEM). Not available on wall mount models.</p>

Conduit Canopy Options (6.31" OD x 4" H)
All conduit covers require a 1.5" deep surface junction box

Aviation Cable (CA)	Pendant Mount (CP)	Surface (CS)
		

COLOR CHART

Standard Finishes (Powder Coat)



Matte Black (MB)



Bronze (BZ)

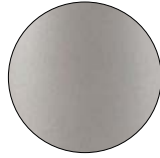

Satin Aluminum (SA)

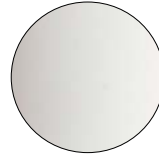

Matte White (MW)

Special Finishes Available. Contact our sales department.

